

1722 Rivscrew

Steel - Dome head

2.8 mm (.110") - 4.0 mm (5/32")

Features

- Threaded, removable speed fasteners that combine the speed of rivet placement with the removability of a screw
- Expands radially during installation to form a thread in host material, eliminating the risk of over torquing and strip-out
- Placed using a hexagon mandrel which expands the threaded diameter radially, adjacent to its six corners
- Removable for servicing with a hex key and reusable
- Providing a higher vibration resistant "thread lock" in the parent material compared to standard screws
- Can be used to fasten most materials up to Vickers hardness 105 Hv5
- Eliminates the need for costly tapping or thread-forming operations
- Can be bowl fed for larger volume applications using automated equipment

Material

- Low carbon steel, zinc plated, clear trivalent passivated
(BS 3111 Type 0, SAE 1008, DIN 1654 Qst 34-3)



Other available options on request:

Tin plated - Replace part no. 01722 with 01723

For assistance, contact your nearest [Gripwell](http://www.gripwell.com) team

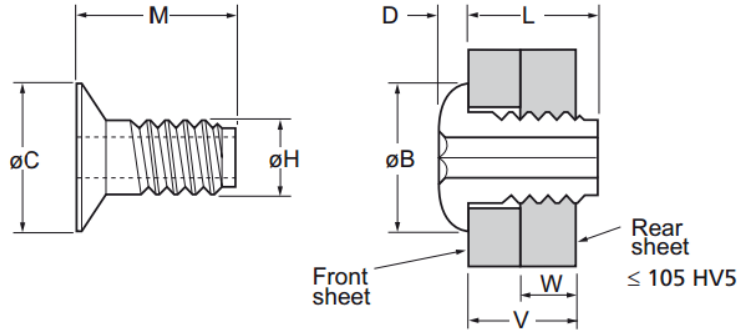

| Part No. | Size ϕ | ϕH | Front Sheet Hole Size | | Rear Sheet Hole Size | | ϕC | M | W | V | $\phi B^{(1)}$ | D ⁽¹⁾ | L | Fasteners per pod | | |
|-------------|----------------|----------|-----------------------|------|----------------------|------|----------|------|------|-----|----------------|------------------|-----|-------------------|------|------|
| | | | min. | max. | min. | max. | | | | | | | | | max. | max. |
| 01722-02806 | 2.8 (.110") | 2.6 | 2.95 | 3.02 | 2.62 | 2.70 | 5.9 | 1.62 | 4.83 | 6.1 | 1.4 | 4.0 | 62 | | | |
| 01722-02807 | | | | | | | | | | | | | 5.2 | 2.85 | 5.0 | 52 |
| 01722-02809 | | | | | | | | | | | | | 6.2 | 3.85 | 6.0 | 43 |
| 01722-02810 | | | | | | | | | | | | | 7.2 | 4.83 | 7.0 | 38 |
| 01722-02812 | | | | | | | | | | | | | 8.2 | 5.82 | 7.0 | 38 |
| 01722-03006 | 3.0 (.118") | 2.8 | 3.07 | 3.15 | 2.82 | 2.89 | 5.9 | 1.62 | 5.82 | 6.1 | 1.4 | 4.0 | 62 | | | |
| 01722-03007 | | | | | | | | | | | | | 5.2 | 2.85 | 5.0 | 52 |
| 01722-03009 | | | | | | | | | | | | | 6.2 | 3.85 | 6.0 | 43 |
| 01722-03010 | | | | | | | | | | | | | 7.2 | 4.83 | 7.0 | 38 |
| 01722-03011 | | | | | | | | | | | | | 8.2 | 5.82 | 8.0 | 34 |
| 01722-03012 | | | | | | | | | | | | | 9.2 | 6.81 | 9.0 | 30 |
| 01722-03016 | 10.1 | 7.80 | 9.0 | 30 | | | | | | | | | | | | |
| 01722-03016 | 13.1 | 10.72 | 11.9 | 23 | | | | | | | | | | | | |

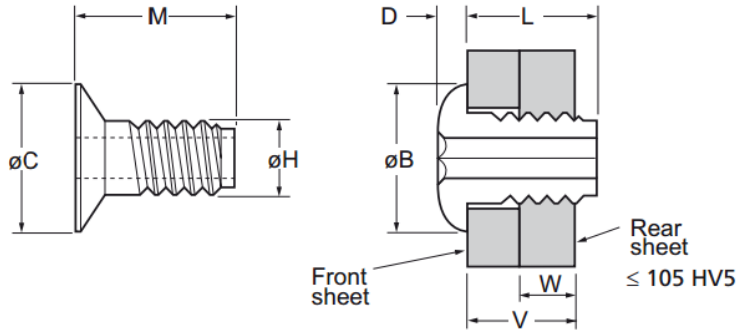

| Part No. | Size ø | øH | Front Sheet Hole Size | | Rear Sheet Hole Size | | øC | M | W | V | øB ⁽¹⁾ | D ⁽¹⁾ | L | Fasteners per pod ± 1 | |
|-------------|----------------|-----|-----------------------|------|----------------------|------|-----|------|------|-----|-------------------|------------------|----|--------------------------|-------|
| | | | min. | max. | min. | max. | | | | | | | | | |
| 01722-03506 | 3.5 (.138") | 3.1 | 3.50 | 3.58 | 3.10 | 3.17 | 6.0 | 1.62 | 2.85 | 6.1 | 1.4 | 4.0 | 62 | | |
| 01722-03507 | | | | | | | | | | | | | | 5.2 | 3.85 |
| 01722-03509 | | | | | | | | | | | | | | 6.2 | 4.83 |
| 01722-03510 | | | | | | | | | | | | | | 7.2 | 5.82 |
| 01722-03511 | | | | | | | | | | | | | | 8.2 | 6.81 |
| 01722-03512 | | | | | | | | | | | | | | 9.2 | 7.80 |
| 01722-03517 | | | | | | | | | | | | | | 10.1 | 11.76 |
| 01722-04006 | 4.0 (5/32") | 3.6 | 4.19 | 4.27 | 3.61 | 3.68 | 6.3 | 1.62 | 2.85 | 6.4 | 1.4 | 4.0 | 62 | | |
| 01722-04007 | | | | | | | | | | | | | | 5.2 | 3.85 |
| 01722-04009 | | | | | | | | | | | | | | 6.2 | 4.83 |
| 01722-04010 | | | | | | | | | | | | | | 7.2 | 5.82 |
| 01722-04011 | | | | | | | | | | | | | | 8.2 | 6.81 |
| 01722-04012 | | | | | | | | | | | | | | 9.2 | 7.80 |
| 01722-04015 | | | | | | | | | | | | | | 10.1 | 9.78 |

(1) Dimensions B and D are generated during the installation process and should only be used as an indication of the minimum space required

| Size ø | Shear | Tension | Hex Key Size |
|-----------|-------|---------|--------------|
| nom. | kN | kN | |
| 2.8 | 0.90 | 0.70 | 1.60 (1/16") |
| 3.0 | 0.90 | 0.80 | 1.60 (1/16") |
| 3.5 | 1.00 | 1.00 | 2.0 (5/64") |
| 4.0 | 1.30 | 1.20 | 2.5 |

Rivscrow® is removable and reusable



Automotive die-cast chassis with PCB



Heatsinks to processor cartridges

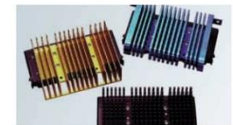

Alternator diode plate to nylon moulding



Semi-conductors to heatsinks and printed circuit boards

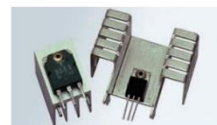

Seat belt tensioner



Assembly Applications

- Aluminium die-cast boxes
- Cast magnesium
- Semi-conductors to thin wall and extruded heatsinks
- Semi-conductors to PCBs
- PCBs to chassis assemblies
- Fastening into injection moulded plastic bosses
- General engineering involving plastics, nylon, polycarbonate etc.



We are proud to be Avdel's authorized distributor of over 30 years